

TRIUMPH TIGER SPORT 660 '22

M O U N T I N G I N S T R U C T I O N S

REF 21542

REINFORCEMENT SUPPORT



1 Person



25 min



EASY



Nº 12



ALLEN

Nº 3
Nº 5

ID	PIEZA/PART	DESCRIPCIÓN	DESCRIPTION	QTY	REF
1		Soporte fijo	Fixed support	1	SOP1P2----21317
2		Tornillo Allen M5x25 Ø11 ISO 7380	M5x25 Ø11 ISO 7380 Allen screw	2	TORNI-I7380-766
3		Casquillo Ø8,5 xØ13 x3,5	Ø8,5 xØ13 x3,5 arrowhead	2	CASQUI-----775
4		Palanca de bloqueo	Locking lever	2	PALANCA---21317
5		Tornillo Allen M5x30 Ø11 ISO 7380	M5x30 Ø11 ISO 7380 Allen screw	2	TORNI-I7380-767
6		Casquillo con valona Ø12xØ6,8x7,3	Ø12xØ6,8x7,3 bush with flange	2	CASQUI-1A---750
7		Arandela de nylon Ø13XØ8X1	Ø13XØ8X1 nylon washer	2	ARAND-N-----265

TRIUMPH TIGER SPORT 660 '22

INSTRUCCIONES DE MONTAJE - MOUNTING INSTRUCTIONS - MONTAGEANLEITUNG

1

DISASSEMBLY
DESMONTAJE

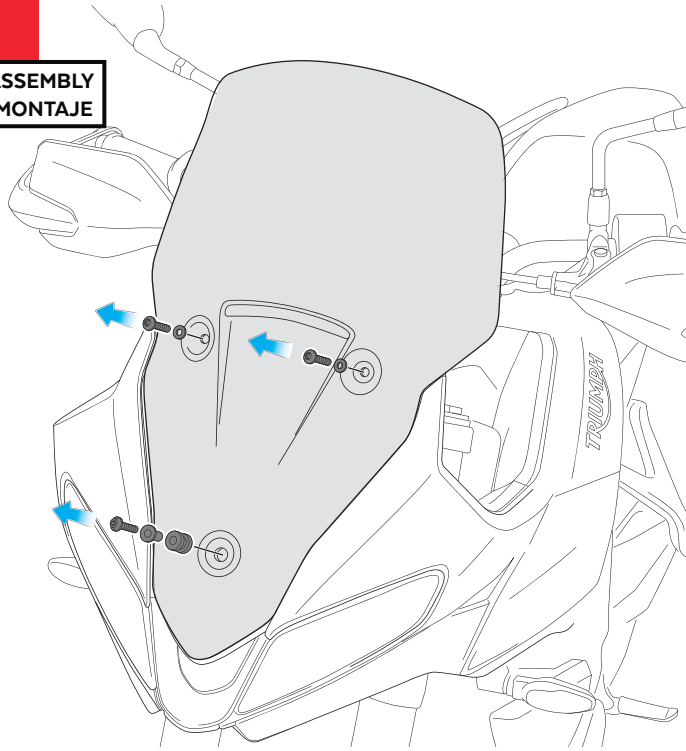

2

DISASSEMBLY
DESMONTAJE

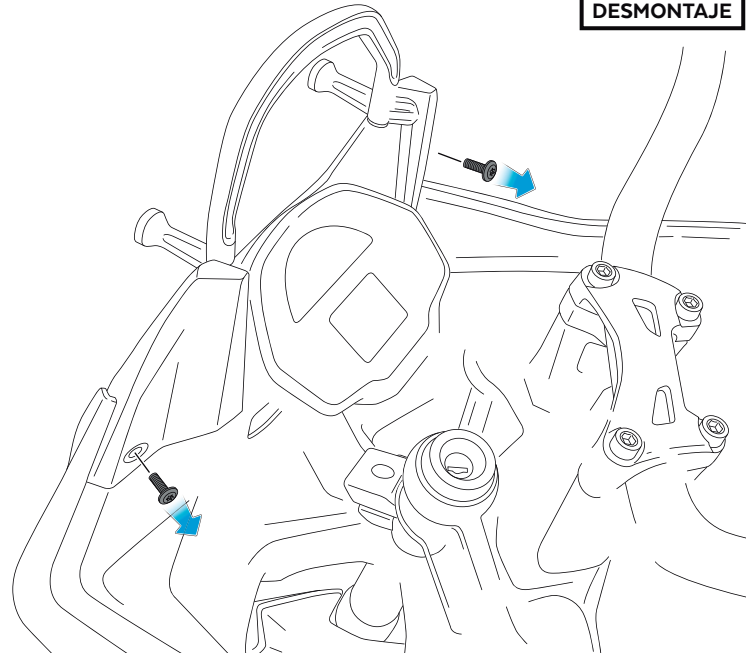

3

DISASSEMBLY
DESMONTAJE

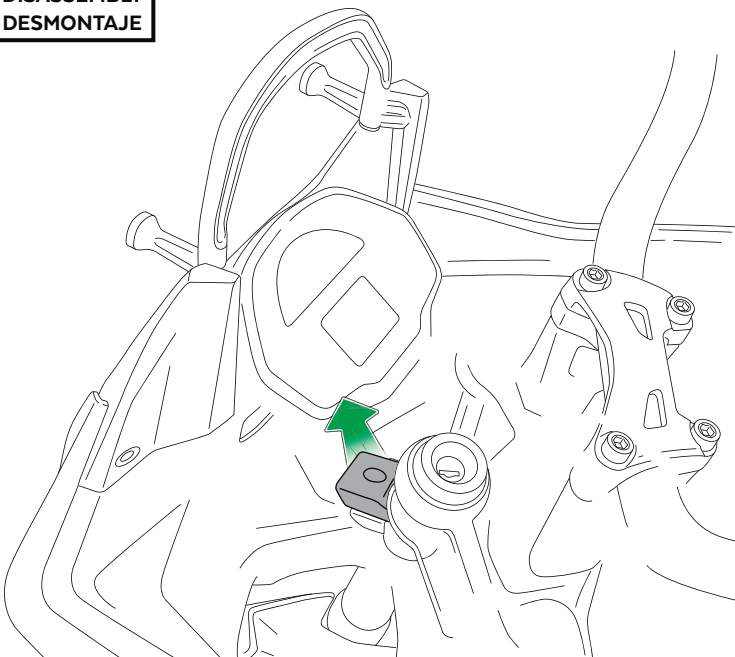

4

DISASSEMBLY
DESMONTAJE

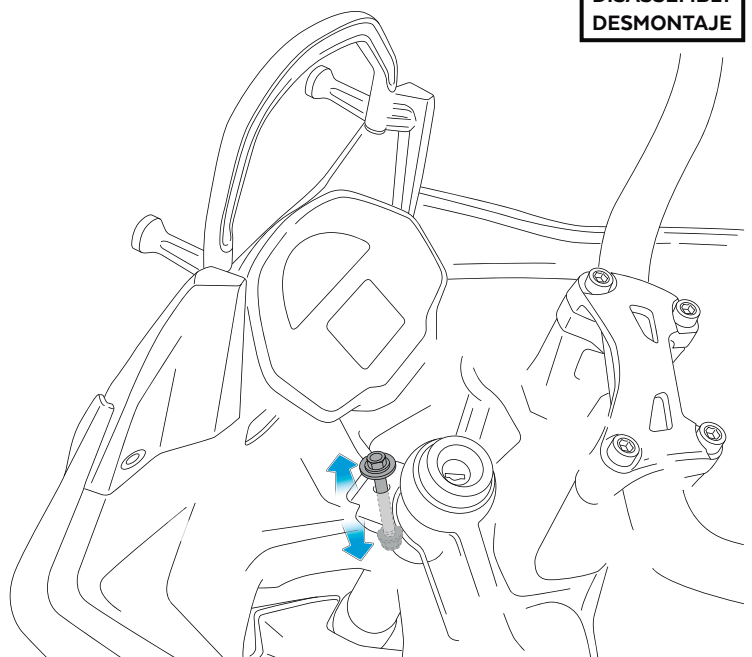

TRIUMPH TIGER SPORT 660 '22

INSTRUCCIONES DE MONTAJE - MOUNTING INSTRUCTIONS - MONTAGEANLEITUNG

5

ASSEMBLY
MONTAJE

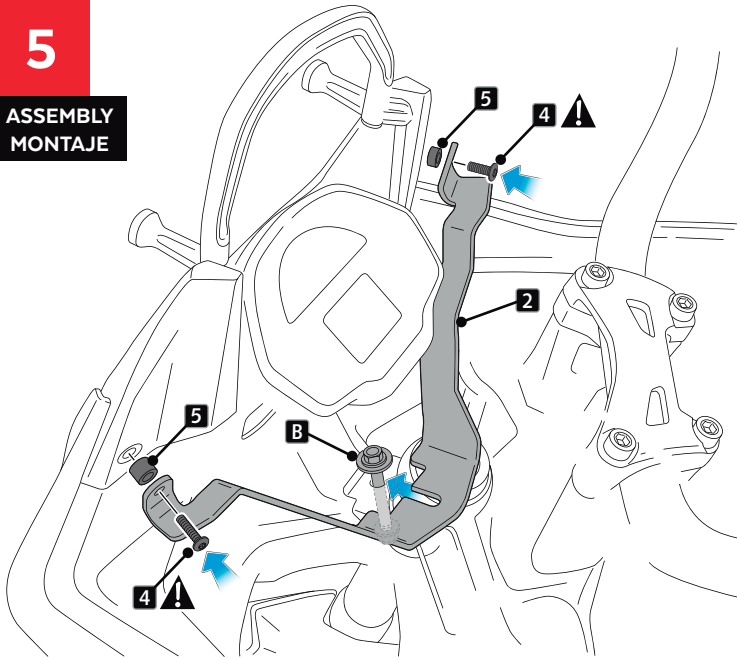

B TORNILLO ORIGINAL
ORIGINAL SCREW

! **4** NO APRETAR
DO NOT TIGHTEN

6

ASSEMBLY
MONTAJE

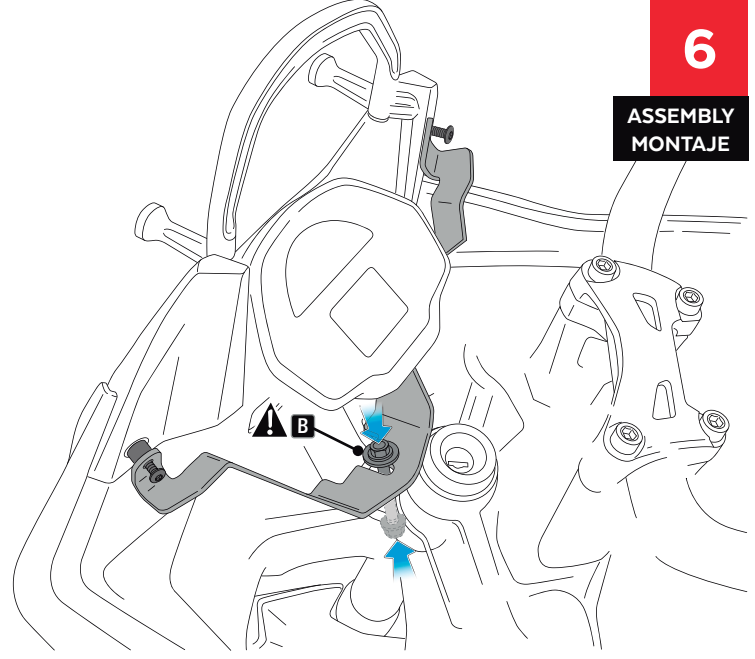

B TORNILLO ORIGINAL
ORIGINAL SCREW

! **B** NO APRETAR
DO NOT TIGHTEN

7

ASSEMBLY
MONTAJE

!
STEP 1.
APRETAR TORNILLOS ID4 / TIGHTEN ID4 SCREWS
STEP 2.
ASEGURAR LA CORRECTA POSICIÓN DEL SOPORTE
Y APRETAR TORNILLO ORIGINAL /
ENSURE THE CORRECT POSITION OF THE SUPPORT
AND TIGHTEN THE ORIGINAL SCREW.

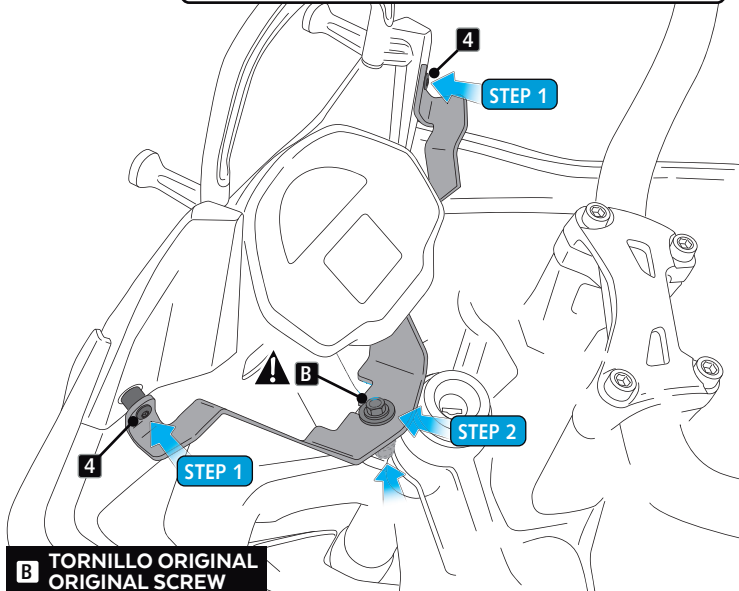

B TORNILLO ORIGINAL
ORIGINAL SCREW

8

DISASSEMBLY
DESMONTAJE

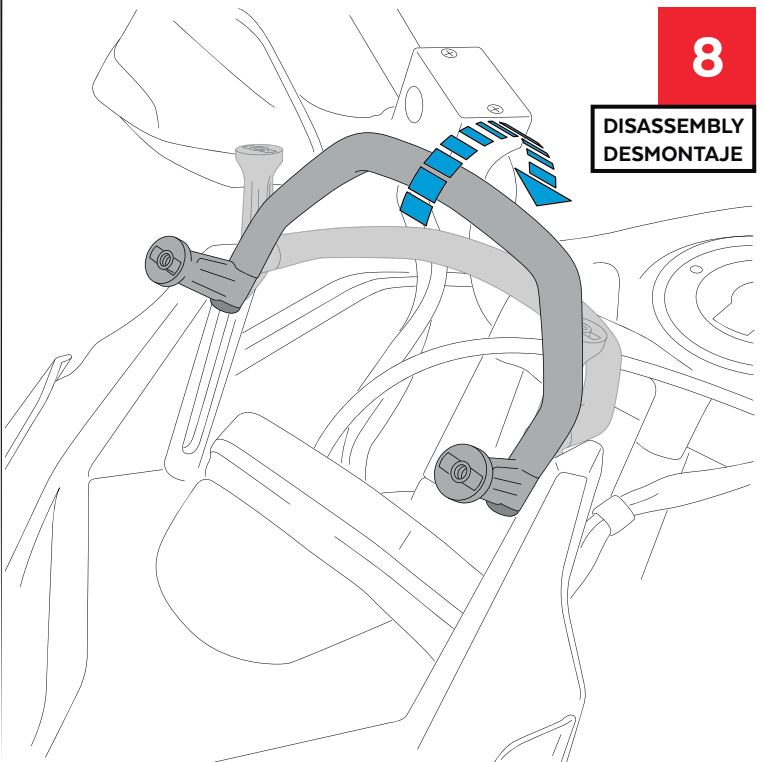

TRIUMPH TIGER SPORT 660 '22

INSTRUCCIONES DE MONTAJE - MOUNTING INSTRUCTIONS - MONTAGEANLEITUNG

9

DISASSEMBLY
DESMONTAJE

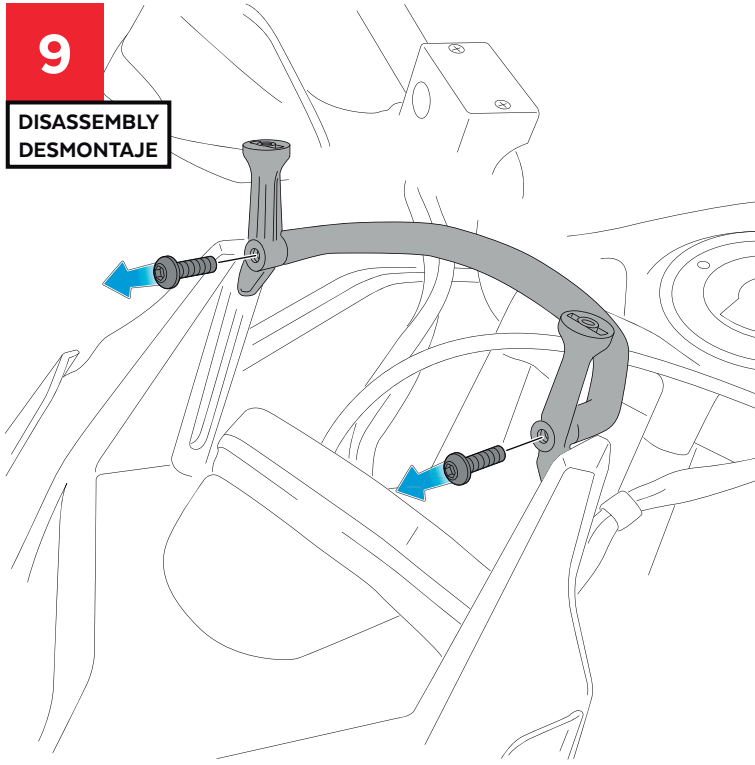

10

ASSEMBLY
MONTAJE

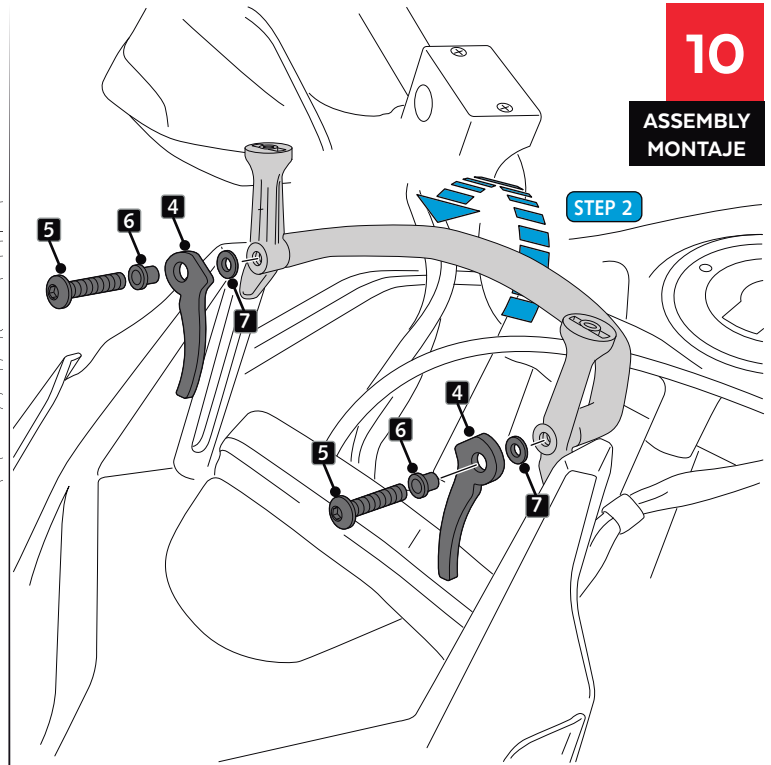

11

ASSEMBLY
MONTAJE

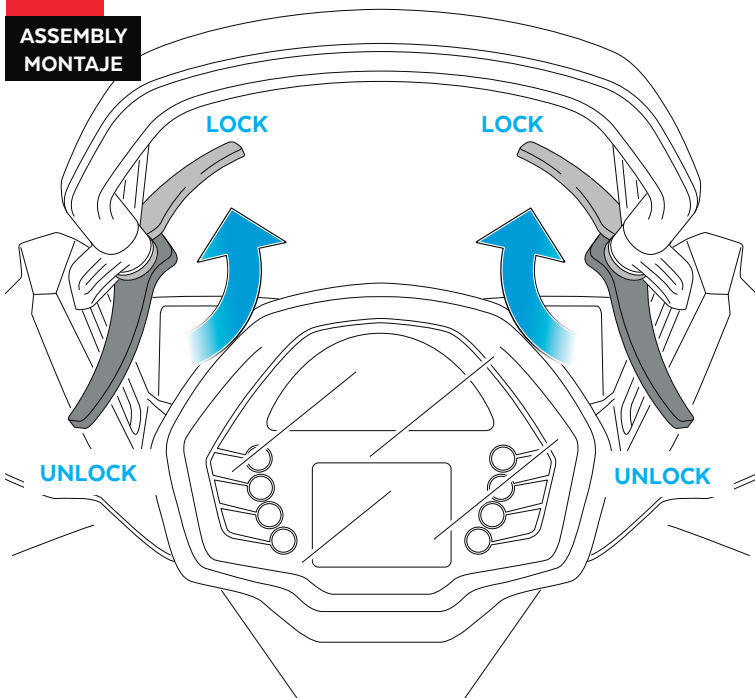

12

ASSEMBLY
MONTAJE

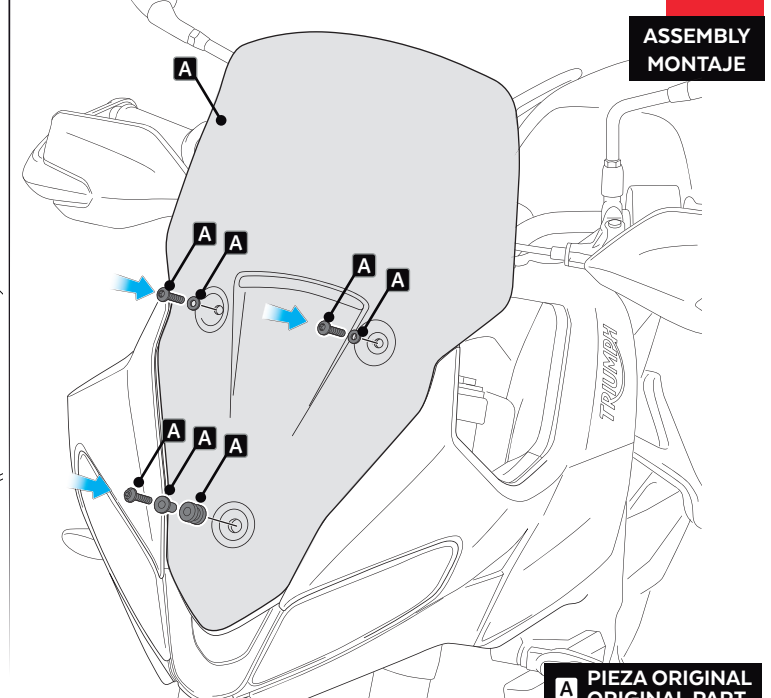

A PIEZA ORIGINAL
ORIGINAL PART