

SUZUKI GSX-8S '23-

M O U N T I N G I N S T R U C T I O N S

REF 21698

ENGINE SPOILER



1 Person



30 min



EASY



PHILLIPS



FIX



Nº 8

ALLEN



Nº 3
Nº 4

ID.	PIEZA/PART	DESCRIPCIÓN	DESCRIPTION	QTY.	REF.:
1		Quilla	Engine spoiler	1	21698J/CM3
2		Soporte izquierdo delantero	Front left support	1	SOPOR4P6FL21698
3		Soporte izquierdo trasero	Rear left support	1	SOPOR4P6RL21698
4		Soporte derecho delantero	Front right support	1	SOPOR4P6FR21698
5		Soporte derecho trasero	Rear right support	1	SOPOR4P6RR21698
6		Silentblock Ø12xØ6x9	Ø12xØ6x9 Silentblock	4	AROPASACABLES-3
7		Casquillo con valona Ø12xØ6,8x7,3	Ø12xØ6,8x7,3 bush with flange	4	CASQUI-1A---750
8		Tornillo allen M5x16 Ø11 ISO 7380	M5x16 Ø11 ISO 7380 allen screw	4	TORNI-I7380-493
9		Tapón tornillo M5 ISO 7380	M5 ISO 7380 screw cap	4	TAPON-----85
10		Tornillo Ø5x20 DIN7505/B	Ø5x20 DIN7505/B screw	2	TORNI-D7505-841
11		Tornillo M6x20 Ø14 ISO7380	M6x20 Ø14 ISO7380 allen screw	1	TORNI-I7380-404
12		Casquillo Ø6,5 xØ13 x8,5mm	Ø6,5 xØ13 x8,5mm arrowhead	1	CASQUI-----0298
13		Tornillo allen M6x10 Ø14 ISO 7380	M6x10 Ø14 ISO 7380 allen screw	2	TORNI-I7380-402

SUZUKI GSX-8S '23-

INSTRUCCIONES DE MONTAJE - MOUNTING INSTRUCTIONS - MONTAGEANLEITUNG

1

ASSEMBLY
MONTAJE

RIGHT SIDE

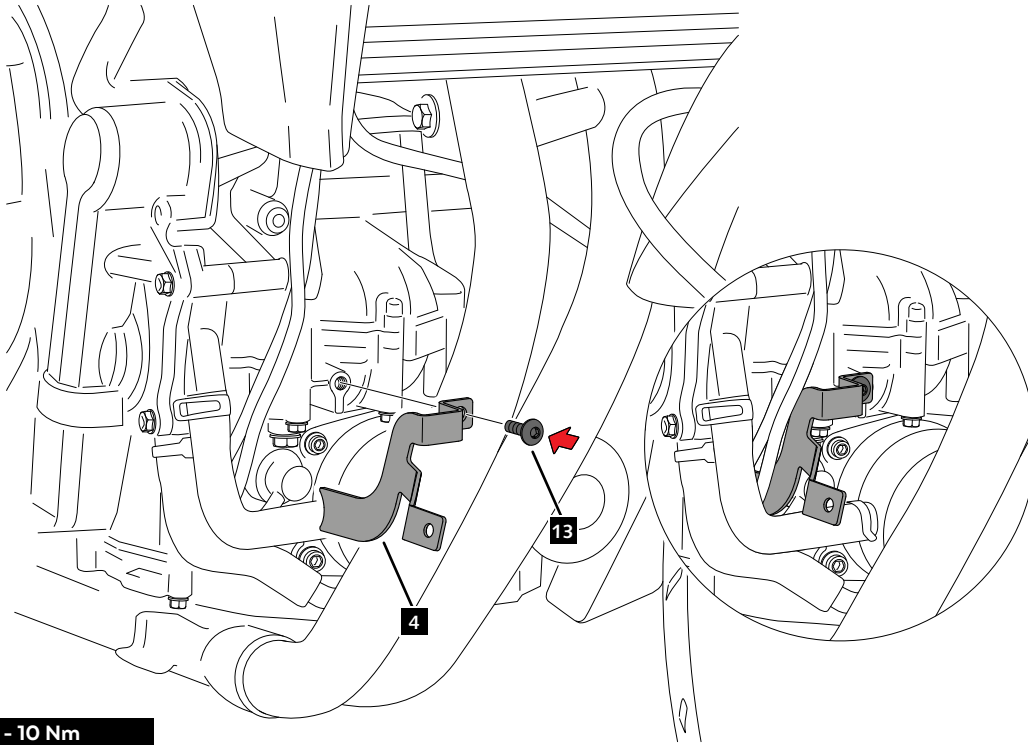

13  Par de apriete - 10 Nm
Tightening torque - 10Nm

2

DISASSEMBLY
DESMONTAJE

RIGHT SIDE

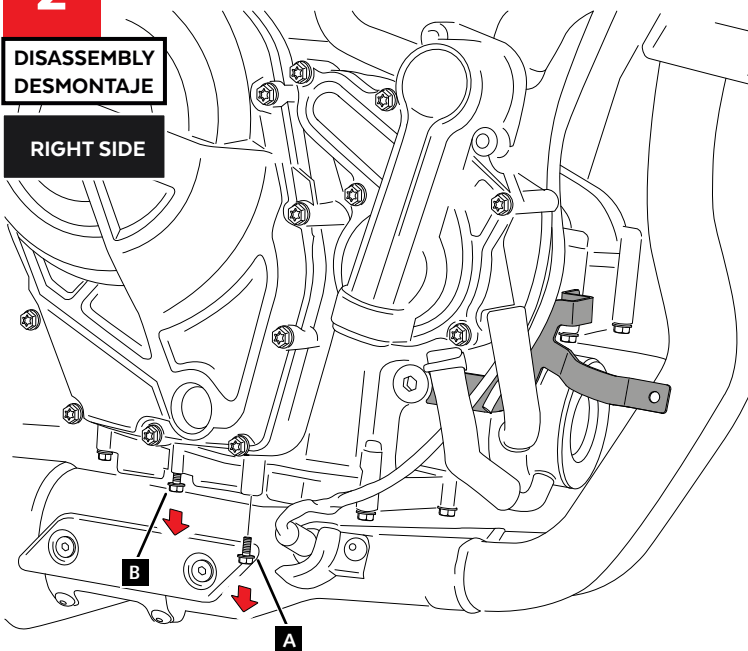

B Solo aflojar
Only loosen

3

ASSEMBLY
MONTAJE

RIGHT SIDE

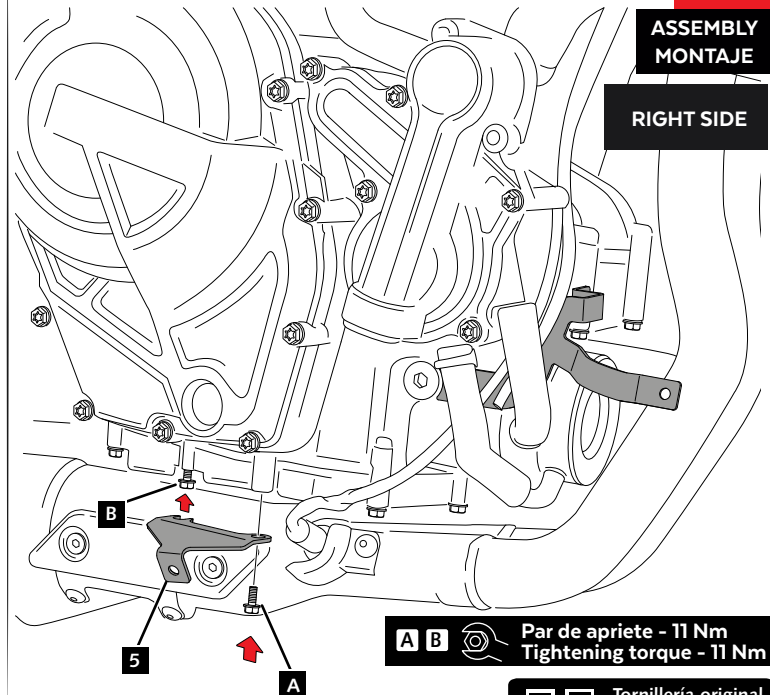

A B  Par de apriete - 11 Nm
Tightening torque - 11 Nm

A B Tornillería original
Original screws

SUZUKI GSX-8S '23-

INSTRUCCIONES DE MONTAJE - MOUNTING INSTRUCTIONS - MONTAGEANLEITUNG

4

**DISASSEMBLY
DESMONTAJE**

LEFT SIDE

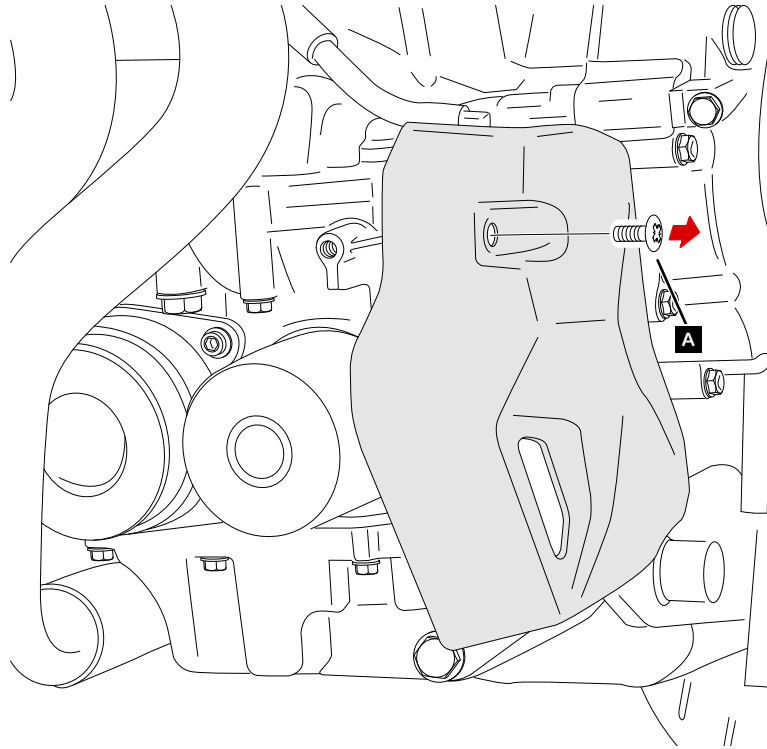

A Tornillería original
Original screws

5

**ASSEMBLY
MONTAJE**

LEFT SIDE

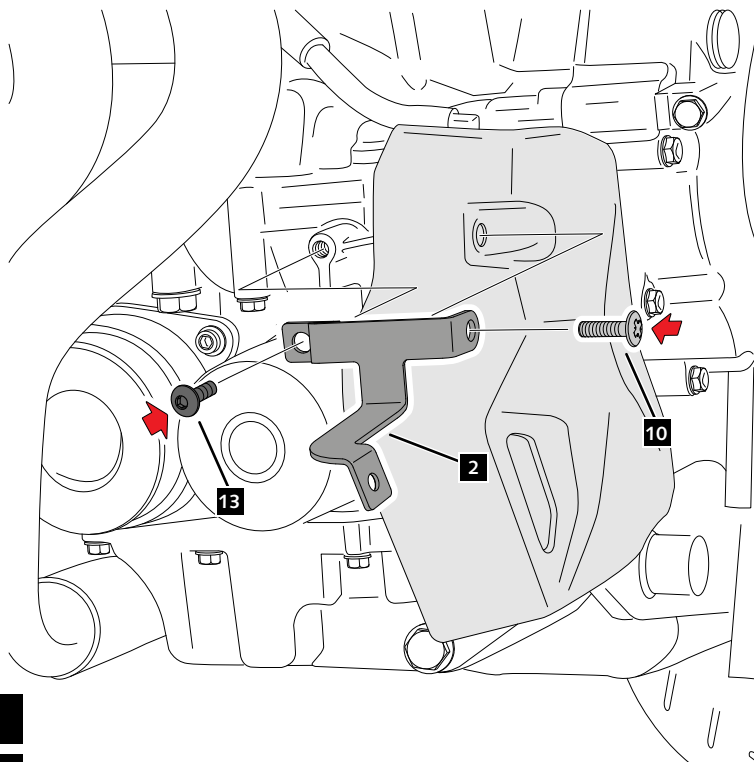

13  Par de apriete - 10 Nm
Tightening torque - 10Nm

10  Par de apriete - 2 Nm
Tightening torque - 2 Nm

SUZUKI GSX-8S '23-

INSTRUCCIONES DE MONTAJE - MOUNTING INSTRUCTIONS - MONTAGEANLEITUNG

6

**DISASSEMBLY
DESMONTAJE**

LEFT SIDE

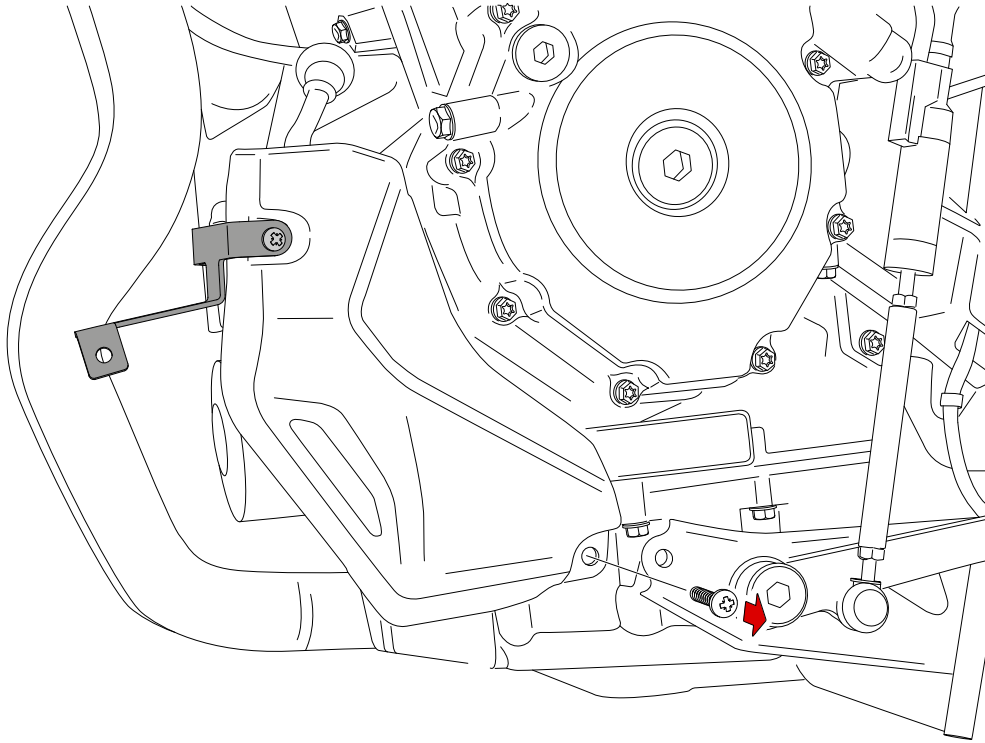



7

**ASSEMBLY
MONTAJE**

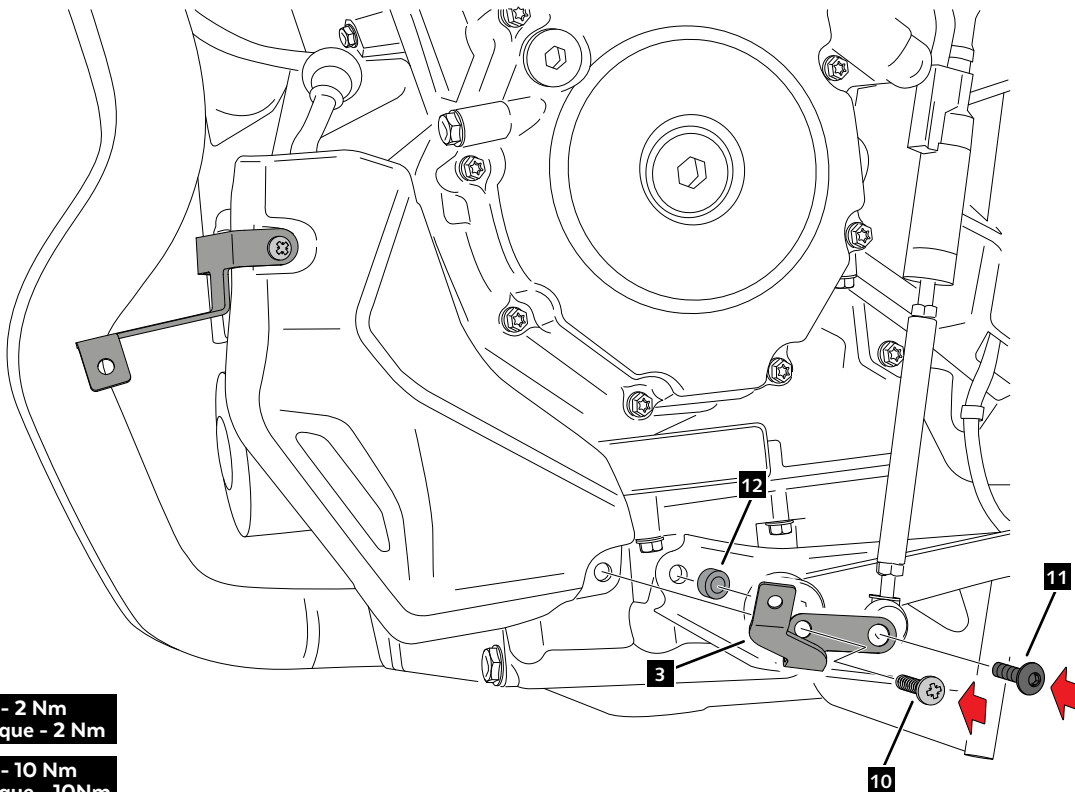
LEFT SIDE



10  Par de apriete - 2 Nm
Tightening torque - 2 Nm

11  Par de apriete - 10 Nm
Tightening torque - 10Nm

SUZUKI GSX-8S '23-

INSTRUCCIONES DE MONTAJE - MOUNTING INSTRUCTIONS - MONTAGEANLEITUNG

8

ASSEMBLY
MONTAJE

LEFT SIDE

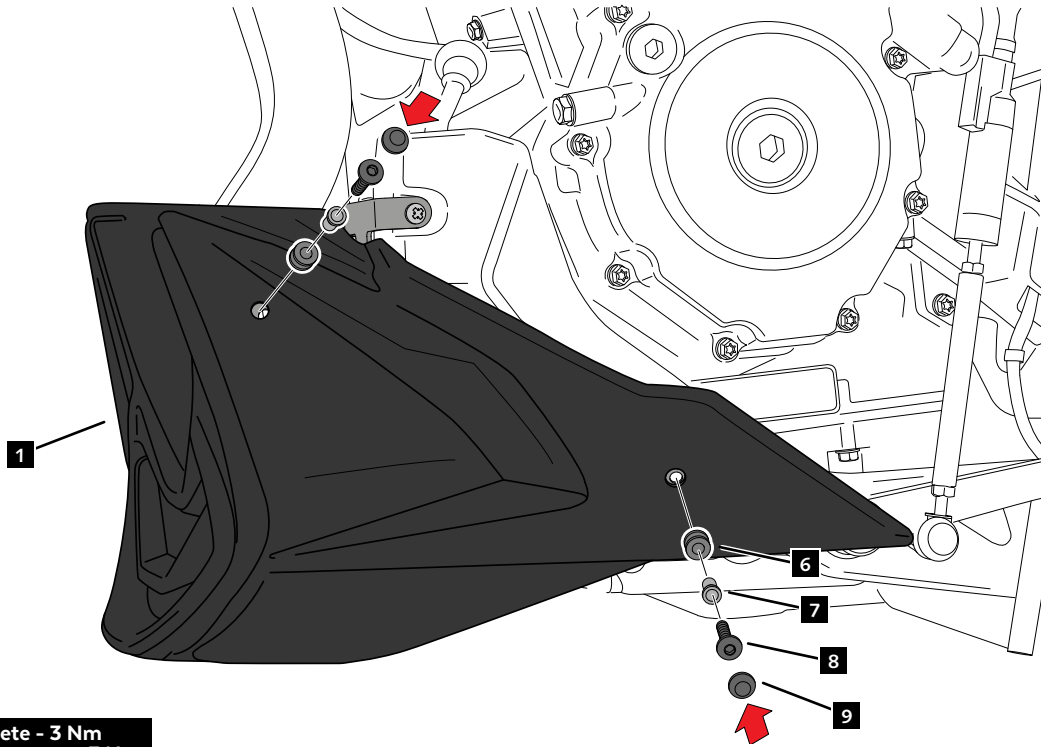



8  Par de apriete - 3 Nm
Tightening torque - 3 Nm

9

ASSEMBLY
MONTAJE

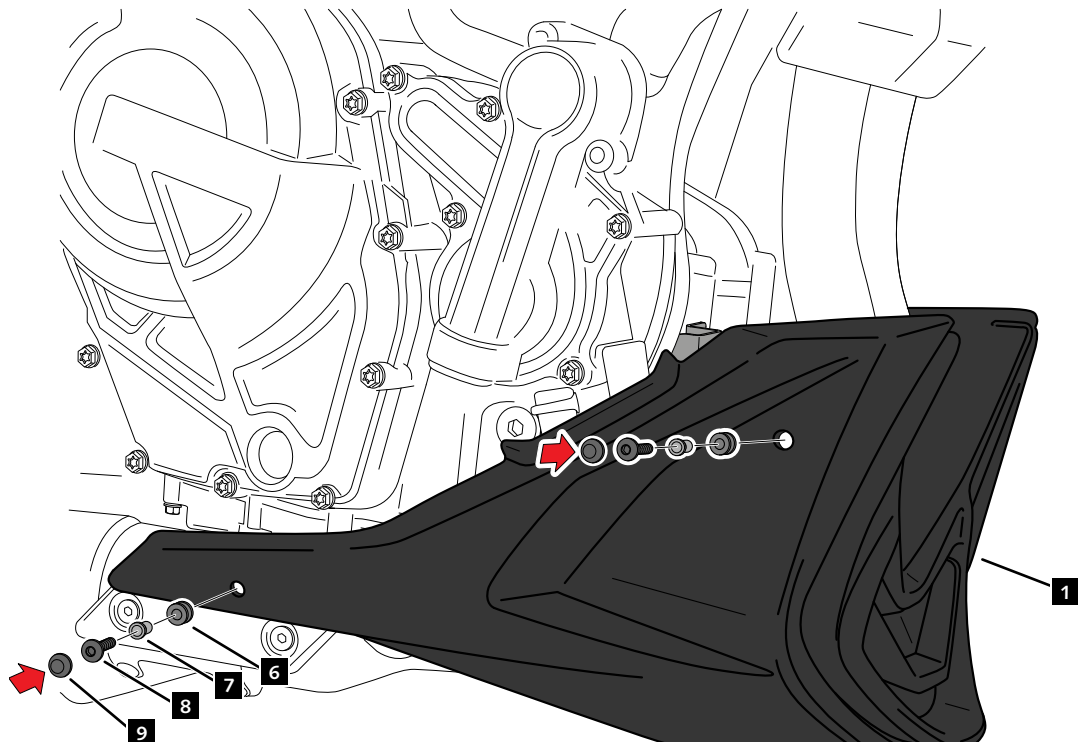
RIGHT SIDE



8  Par de apriete - 3 Nm
Tightening torque - 3 Nm