



DIFFICULTY LEVEL

# SHAD

BCN

## KAWASAKI KLE 500 '26

TOP MASTER  
K0KL56ST

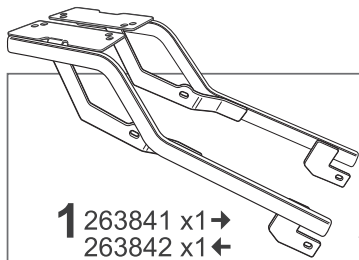

**1** 263841 x1 →  
263842 x1 ←

**2** 261460 x2  
Ø18 Ø11 Ø45

**3** 303045 x4  
Ø8

**4** 303027 x4  
Ø8

**5** 304172 x2  
M8x70 DIN 7380

**6** 261072 x2  
Ø20 Ø9 Ø32

**7** 304170 x2  
M8x60 DIN 7380

### WARNING!

**(GB)** Do not fully tighten the screws until it is ensured that the KIT is correctly attached and aligned. Check tightness every 4 months.

**(E)** No apretar los tornillos del todo hasta asegurarse que el KIT está correctamente colocado y alineado. Repasar apriete cada 4 meses.

**(D)** Ziehen Sie die Schrauben nicht ganz fest, bevor Sie sich nicht vergewissert haben, daß der Bausatz korrekt eingestellt und ausgerichtet ist. Alle 4 Monate Drehmoment überprüfen.

**(I)** Non stringere del tutto le viti fin tanto non si è sicuri che il kit è collocato correttamente e allineato. Controllare il serraggio delle viti ogni 4 mesi.

**(F)** Ne pas serrer les vis avant d'être sûr que le KIT soit correctement positionné et ajusté. Vérifier le serrage des vis tous les 4 mois.

**ATTENTION:** For a full equip assembly, mount the Top master before the 3P or 4P system.

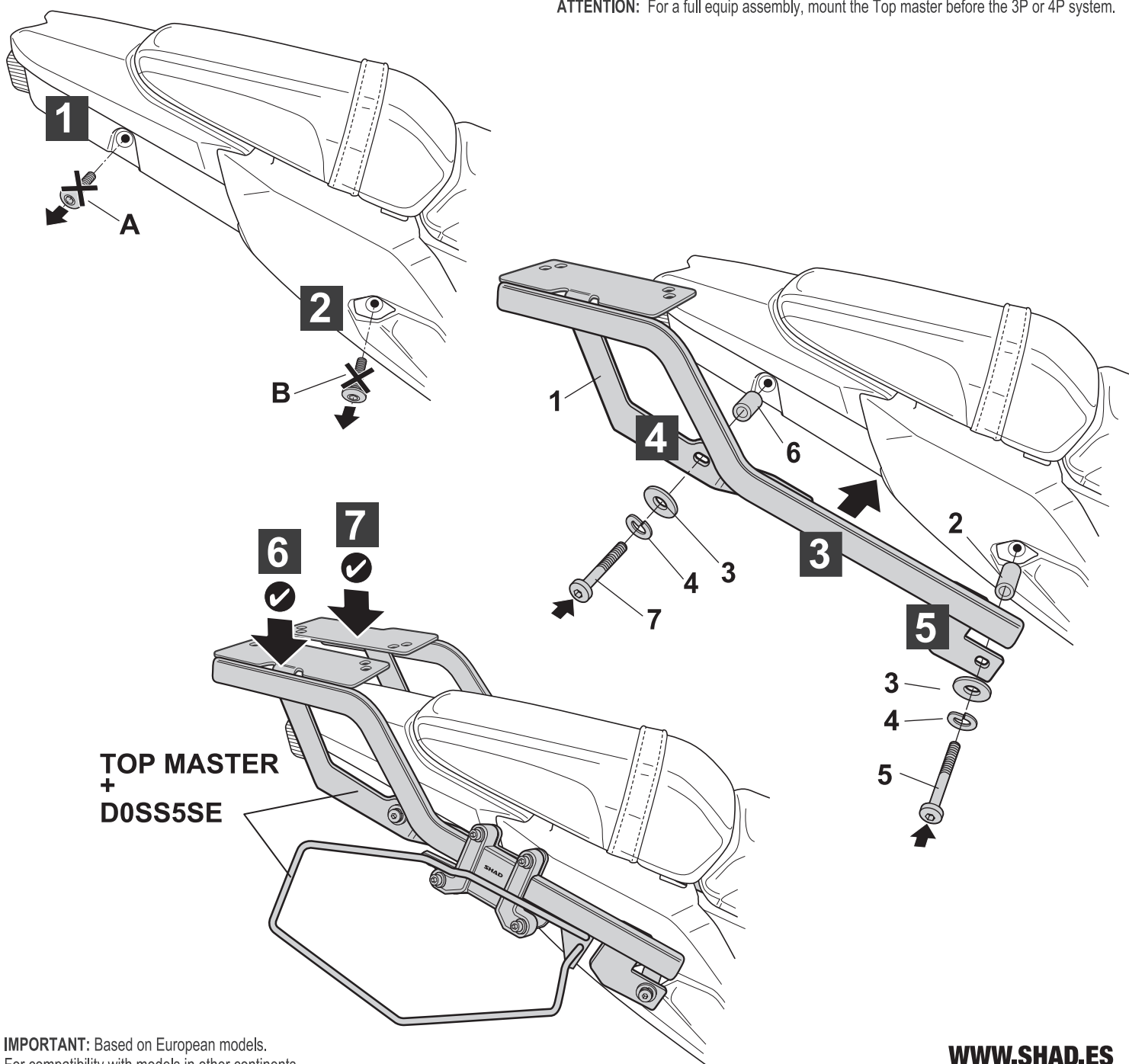

**TOP MASTER  
+  
D0SS5SE**

**IMPORTANT:** Based on European models.  
For compatibility with models in other continents,  
check [www.shad.es](http://www.shad.es)

**WWW.SHAD.ES**

REF. 500479 Edition 1ª