

DUCATI PANIGALE V2 '20- / V4 '18-'19 / V4 25 ANNIVERSARIO 916 '20-
/ V4 S '18-'19 / V4 CORSE '19-'20 / V4 SPECIALE '18-'19

REF 9690

R- RACER SCREEN



1 Person



45 min



MEDIUM



TORX T° 7



ALLEN N° 3
N° 4

ID	PIEZA/PART	DESCRIPCIÓN	DESCRIPTION	QTY	REF
1		Cúpula Racing	Racing screen	1	9690F/H/R/W/NM3

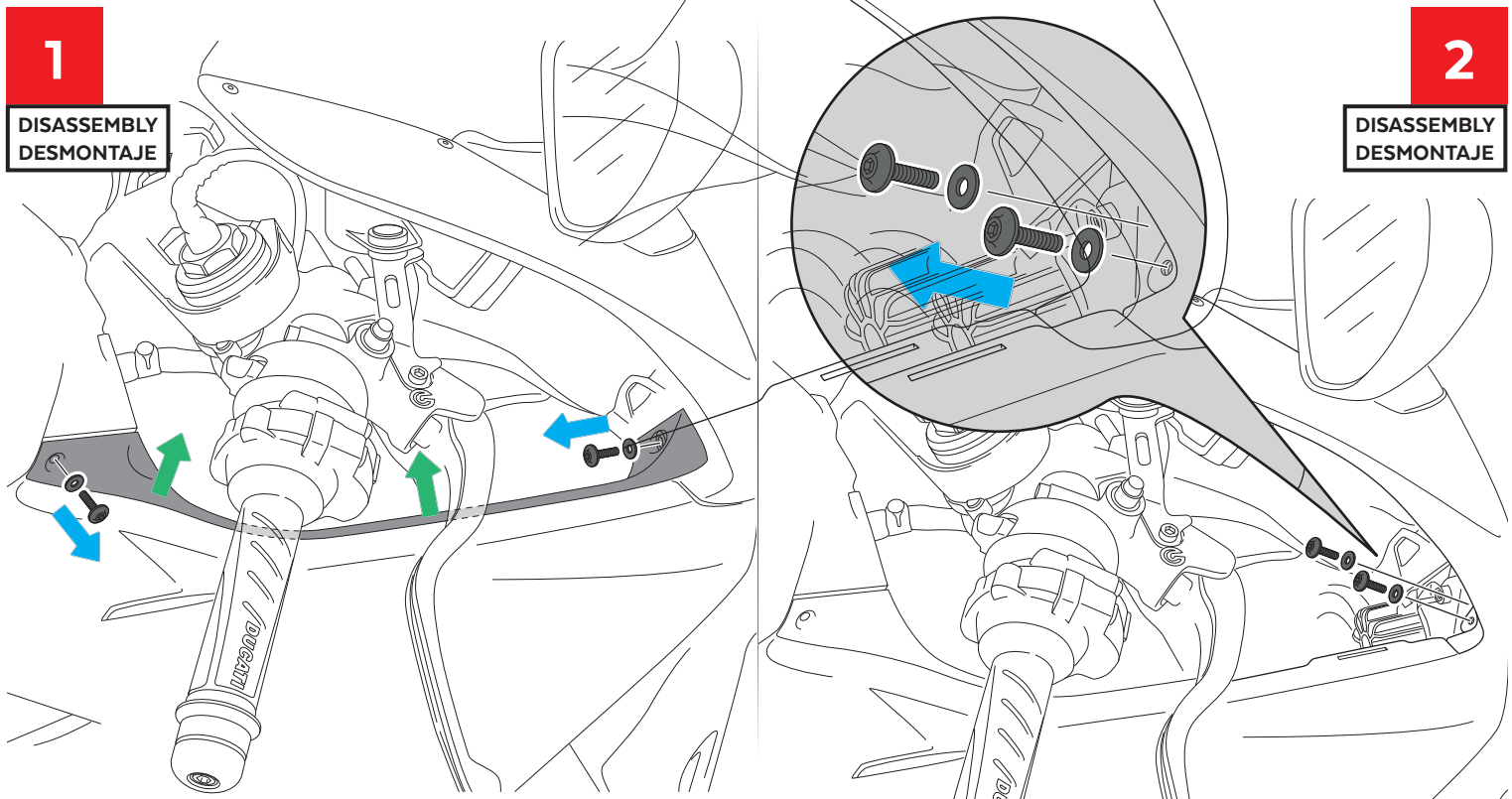

1

DISASSEMBLY
DESMONTAJE

2

DISASSEMBLY
DESMONTAJE

DUCATI PANIGALE V2 '20- / V4 '18-'19 / V4 25 ANNIVERSARIO 916 '20-
/ V4 S '18-'19 / V4 CORSE '19-'20 / V4 SPECIALE '18-'19

INSTRUCCIONES DE MONTAJE - MOUNTING INSTRUCTIONS - MONTAGEANLEITUNG

3

DISASSEMBLY
DESMONTAJE

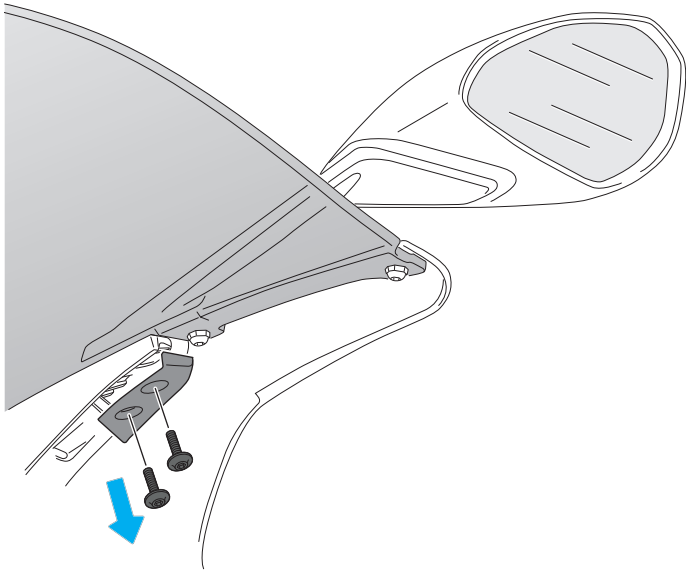

4

DISASSEMBLY
DESMONTAJE

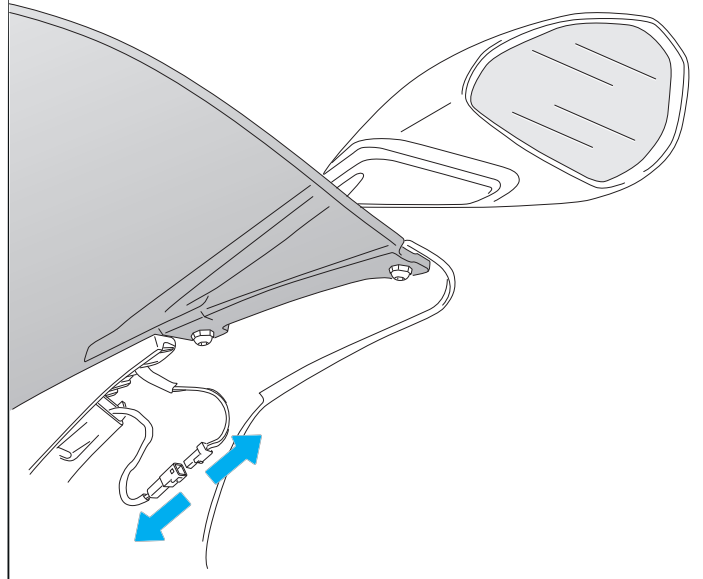

5

DISASSEMBLY
DESMONTAJE

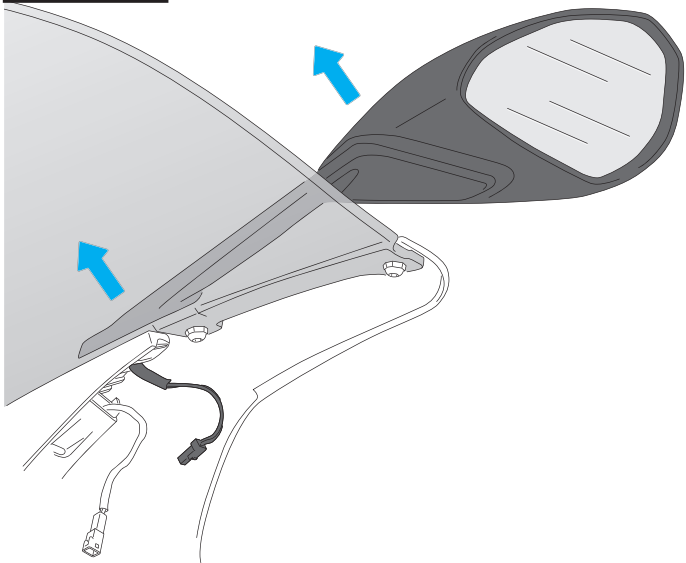

6

DISASSEMBLY
DESMONTAJE

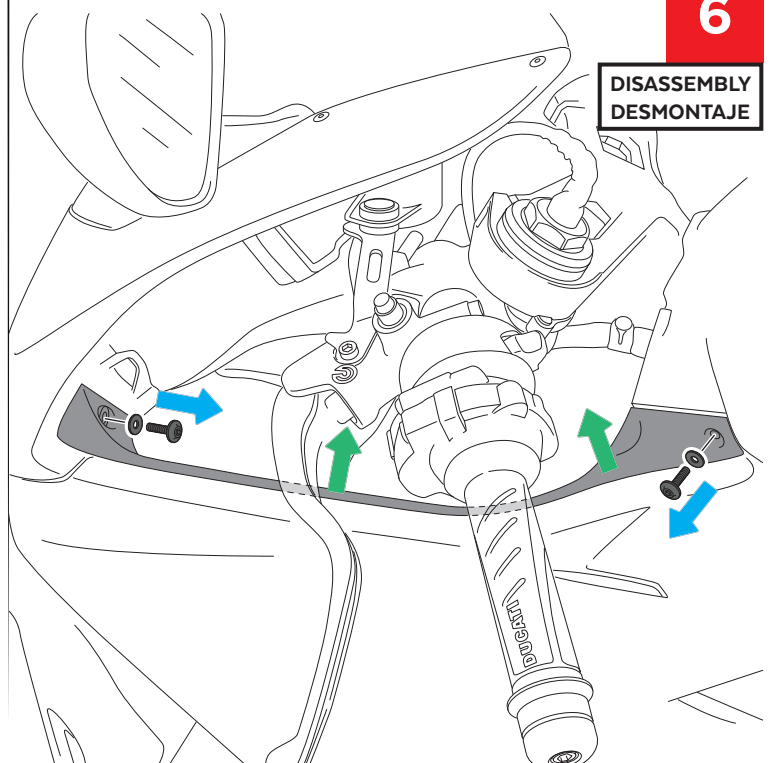

DUCATI PANIGALE V2 '20- / V4 '18-'19 / V4 25 ANNIVERSARIO 916 '20-
/ V4 S '18-'19 / V4 CORSE '19-'20 / V4 SPECIALE '18-'19

ISTRUCCIONES DE MONTAJE - MOUNTING INSTRUCTIONS - MONTAGEANLEITUNG

7

DISASSEMBLY
DESMONTAJE

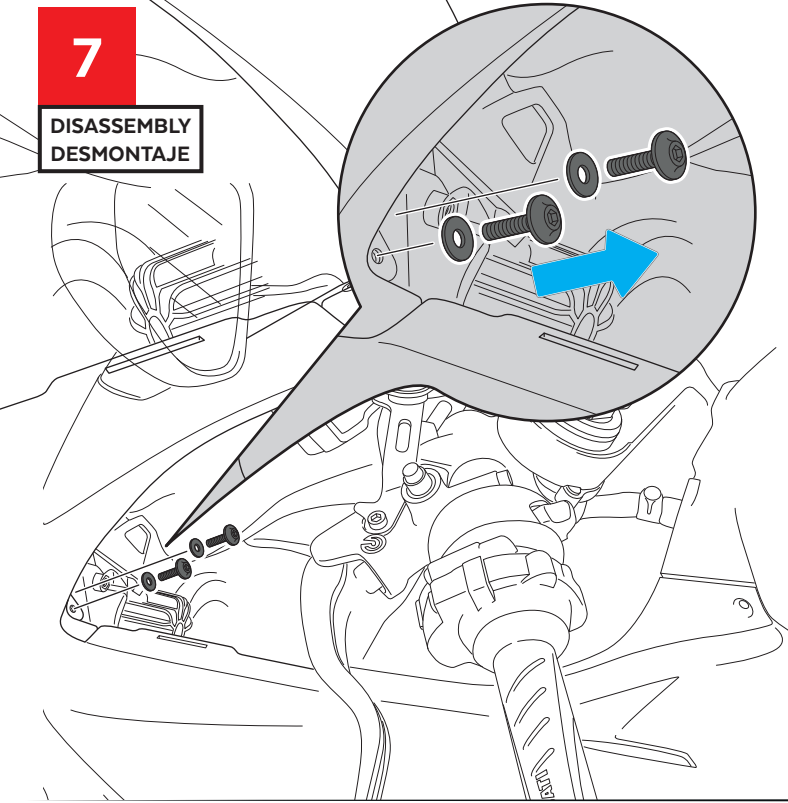

8

DISASSEMBLY
DESMONTAJE

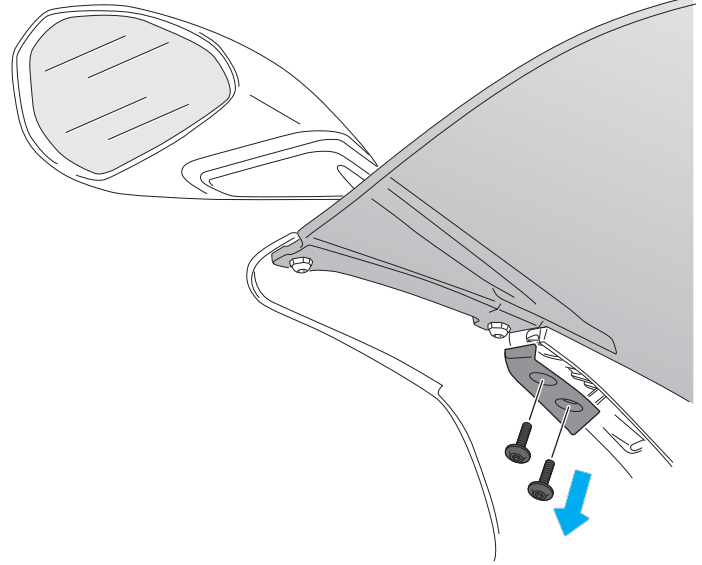

9

DISASSEMBLY
DESMONTAJE

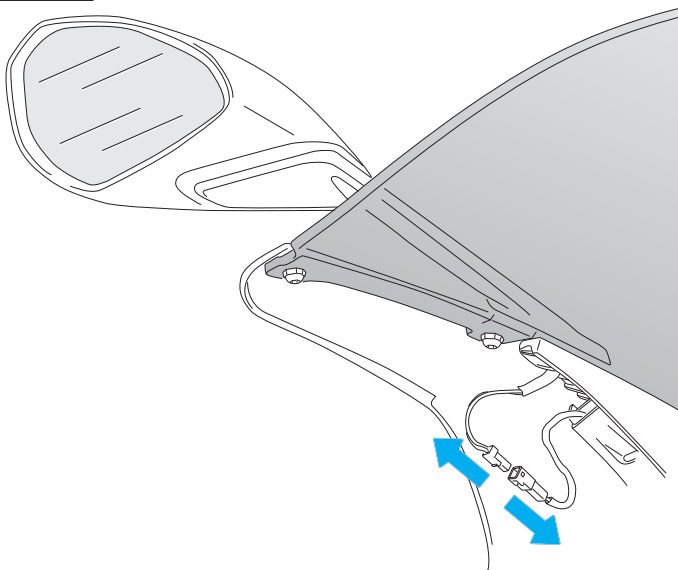

10

DISASSEMBLY
DESMONTAJE

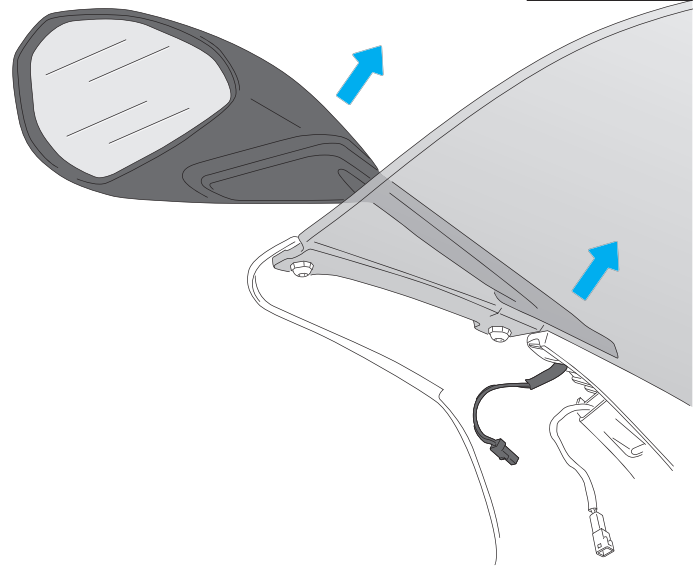

**DUCATI PANIGALE V2 '20- / V4 '18-'19 / V4 25 ANNIVERSARIO 916 '20-
/ V4 S '18-'19 / V4 CORSE '19-'20 / V4 SPECIALE '18-'19**

INSTRUCCIONES DE MONTAJE - MOUNTING INSTRUCTIONS - MONTAGEANLEITUNG

11

**DISASSEMBLY
DESMONTAJE**

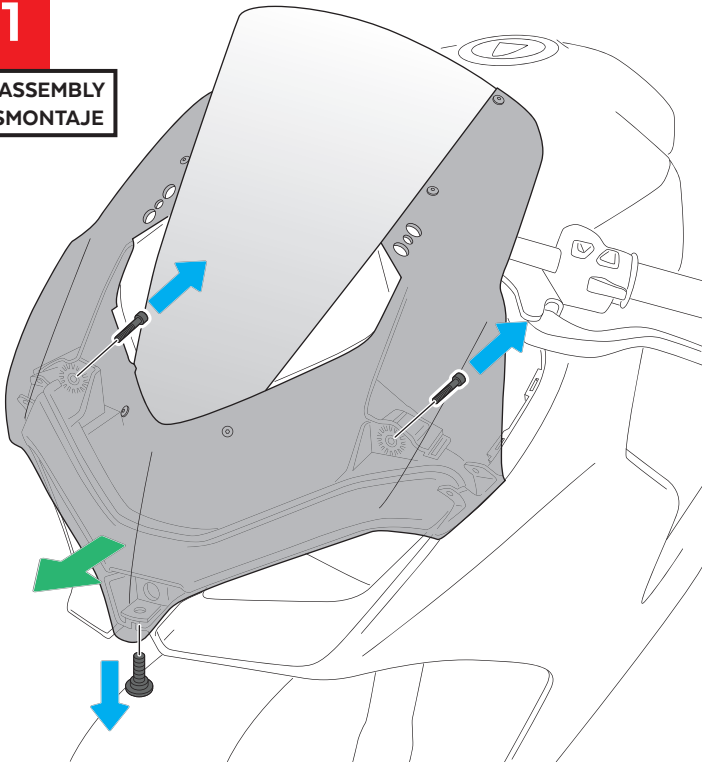

12

**DISASSEMBLY
DESMONTAJE**

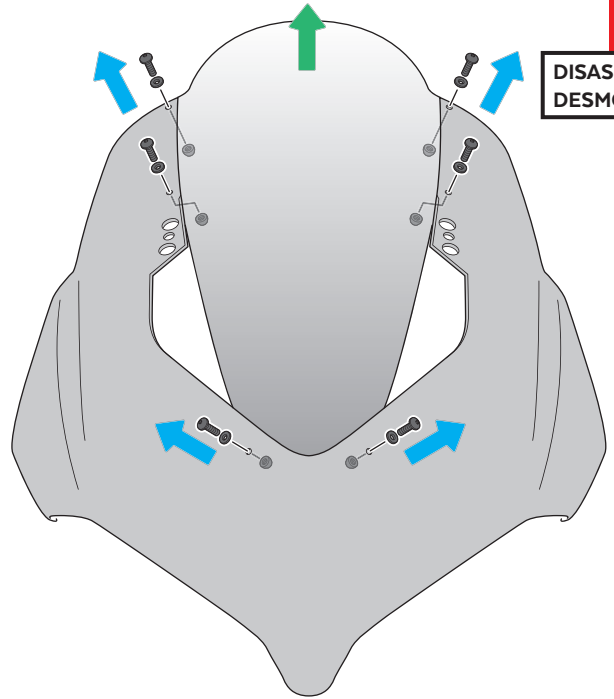

13

**ASSEMBLY
MONTAJE**

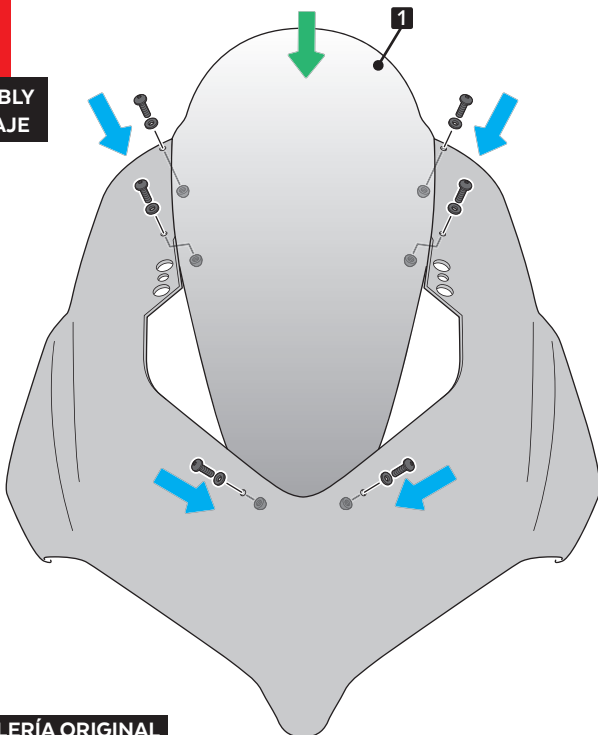

**TORNILLERÍA ORIGINAL
ORIGINAL SCREWS**

PARA FINALIZAR EL MONTAJE DEL CARENADO, VOLVER A COLOCAR LA TORNILLERÍA SEGÚN VIÑETAS DE LA 11 A LA 1.

IN ORDER TO FINISH THE ASSEMBLY OF THE FAIRING, PLACE THE SCREWS BACK ON ACCORDING TO DRAWINGS 11 TO 1.