



**Kawasaki**  
**H2 SX Radiator Guard**

**Installation Instructions**



### Kit Contents PRN012366

- Ⓐ 1 x M6 Special Washer
- Ⓑ 8 x 4mm Neoprene Strips



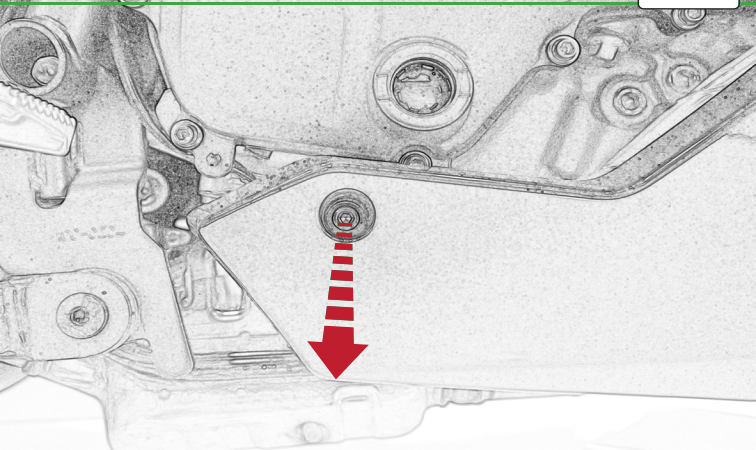

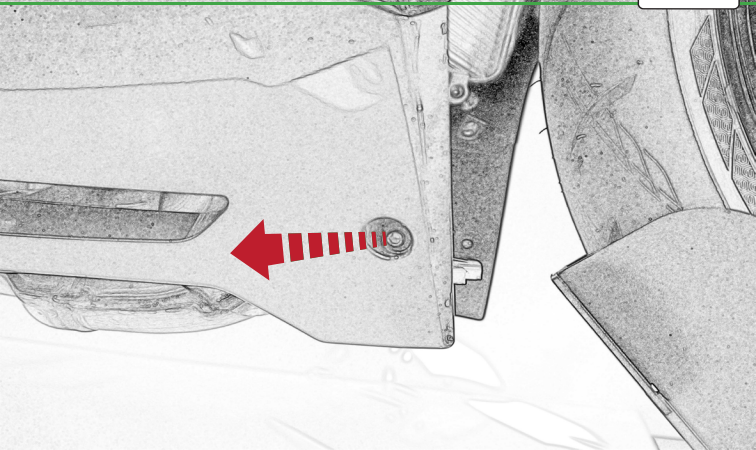



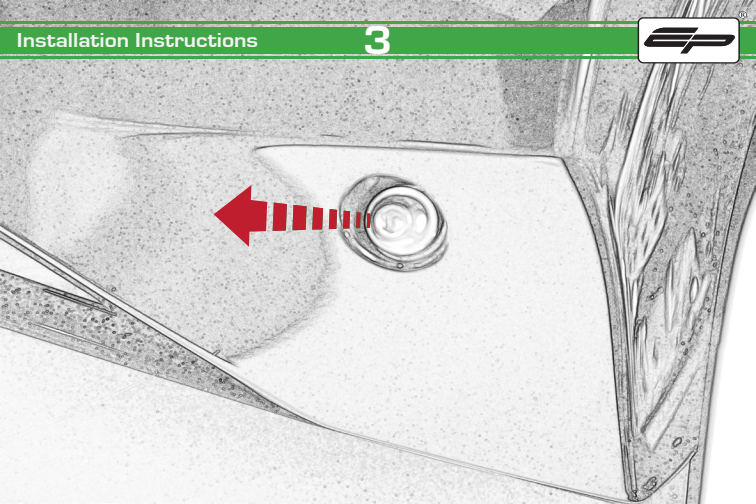

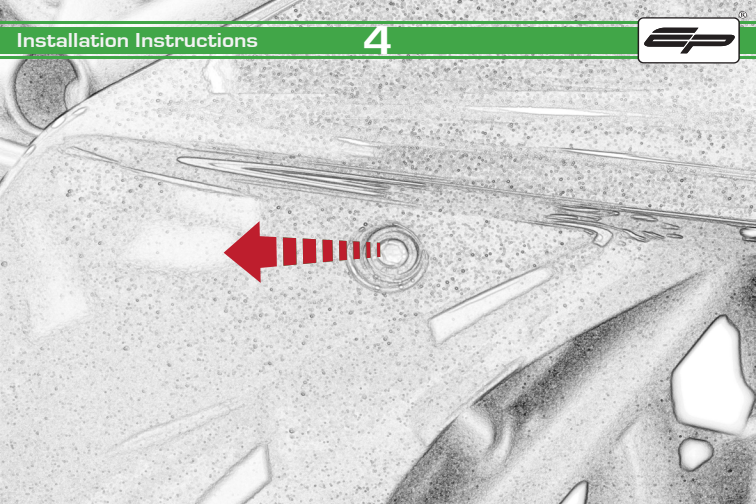

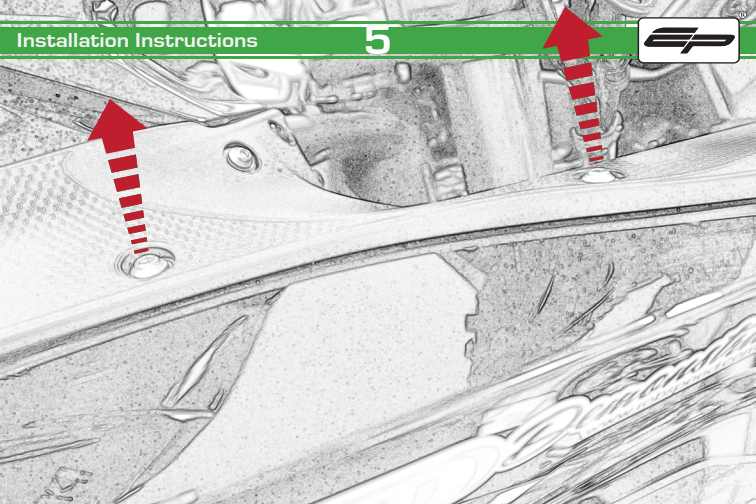



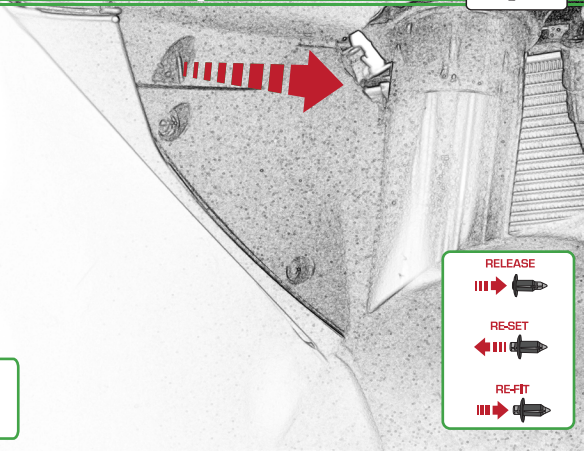

Repeat  
Both Sides

RELEASE



RE-SET



RE-FIT



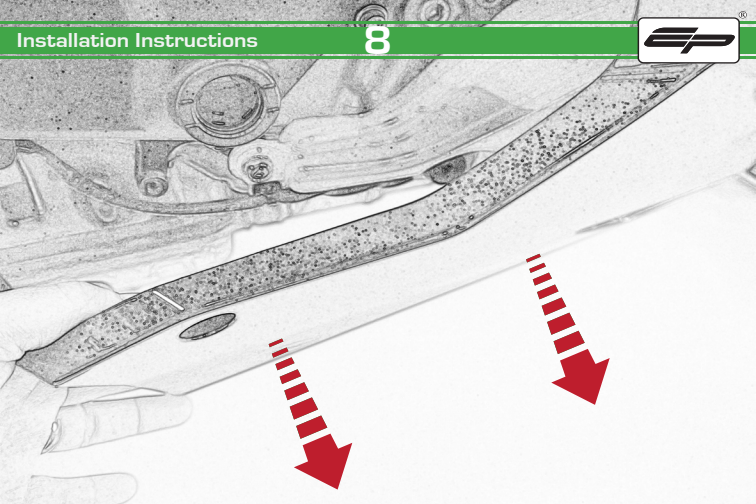

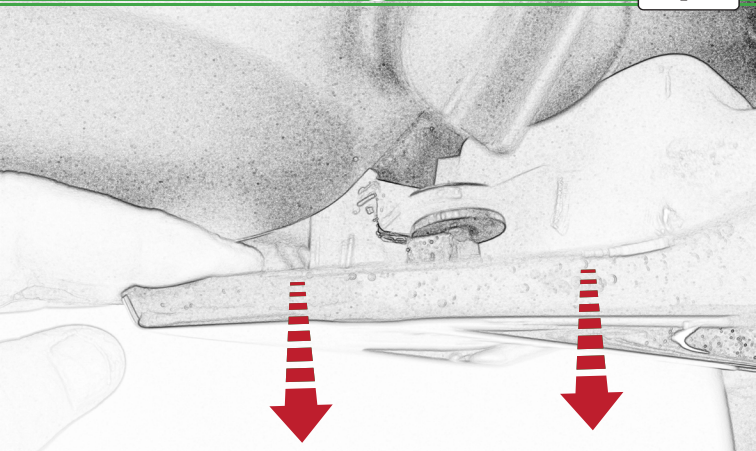

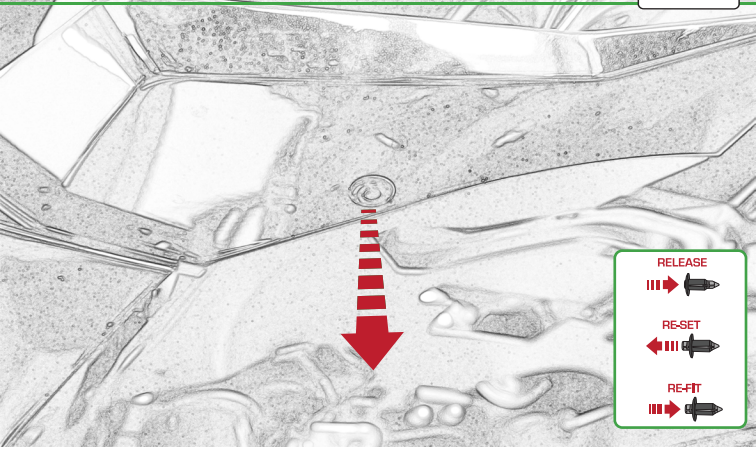

RELEASE



RE-SET



RE-FIT





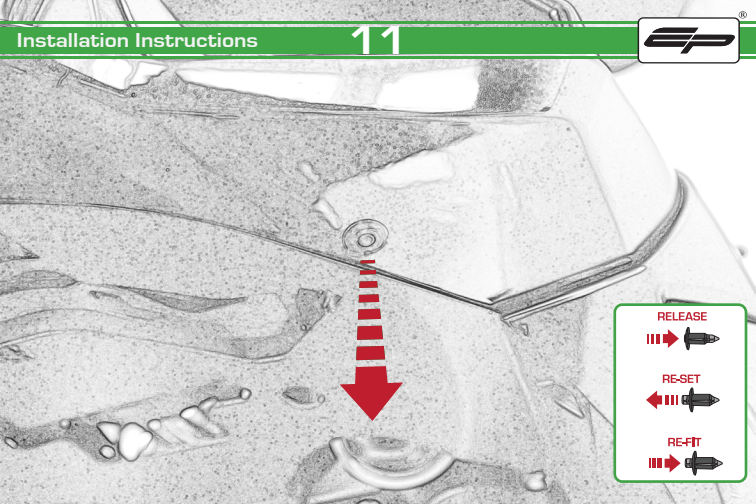

RELEASE



RE-SET



RE-FIT



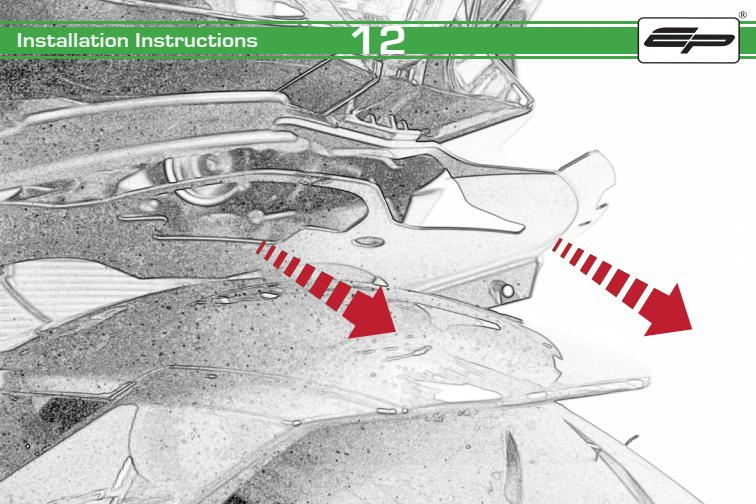

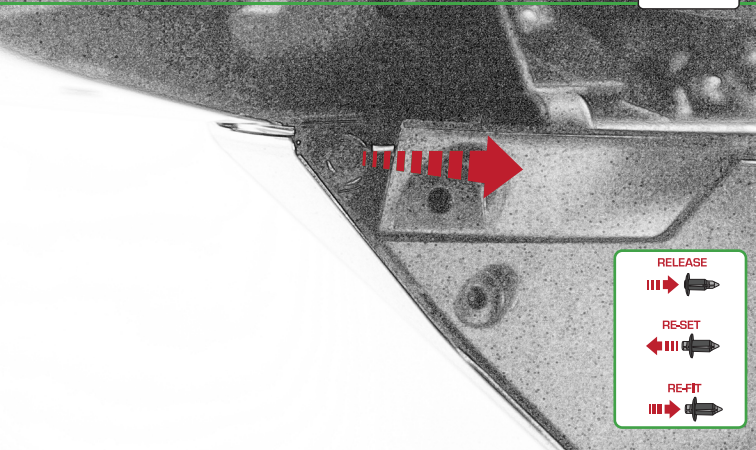

**RELEASE**



**RE-SET**



**RE-FIT**



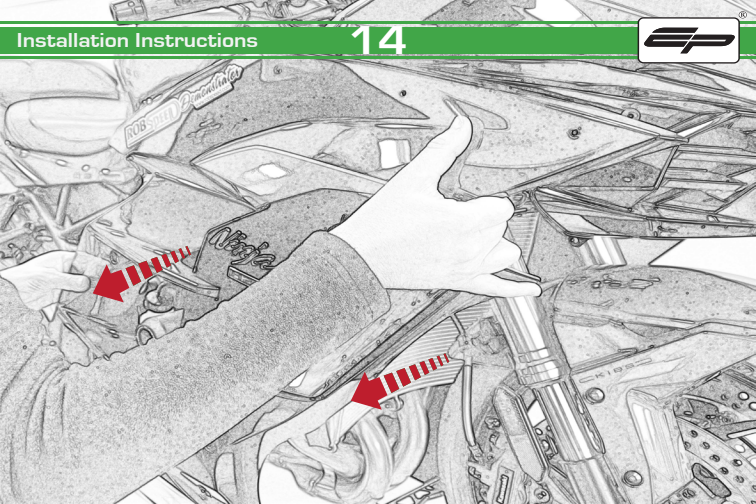

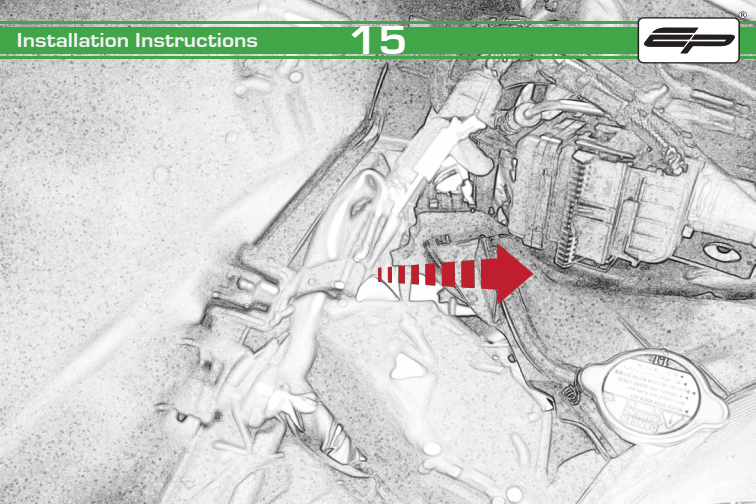

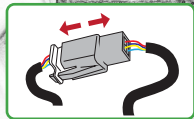
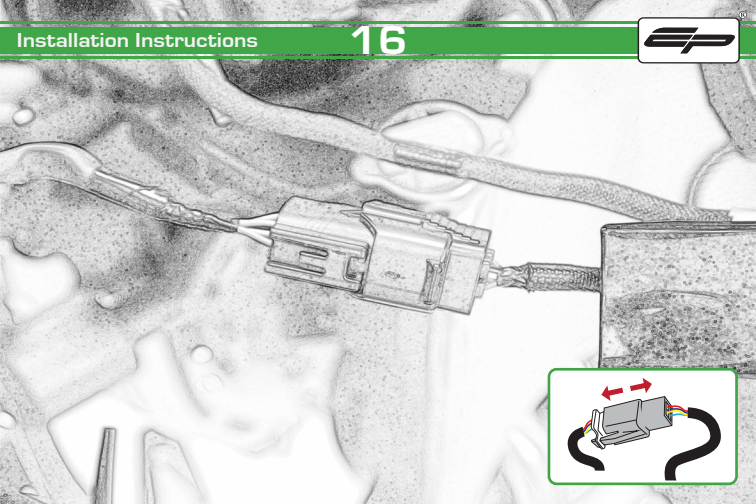

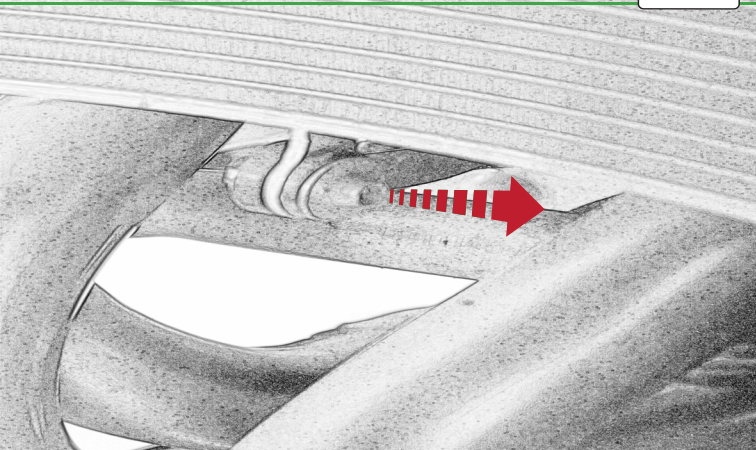

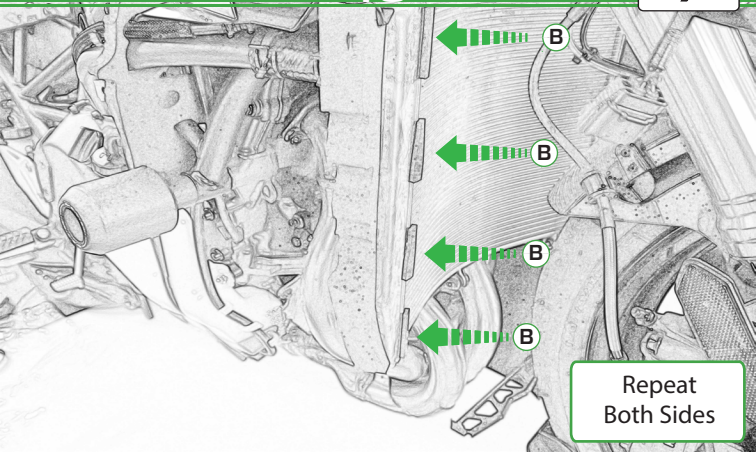

Repeat  
Both Sides



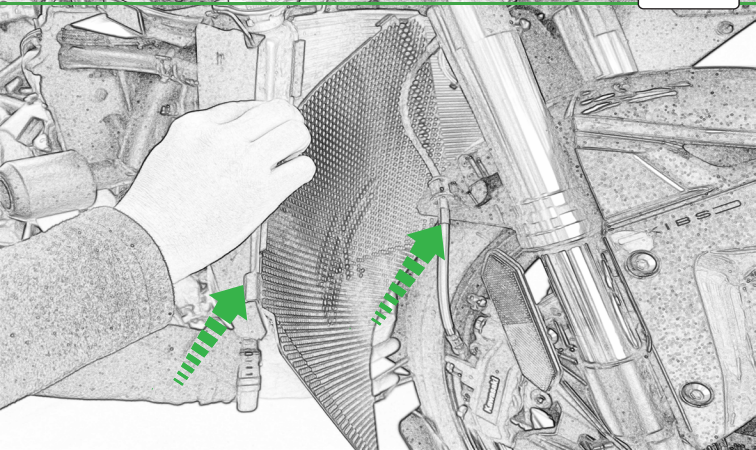

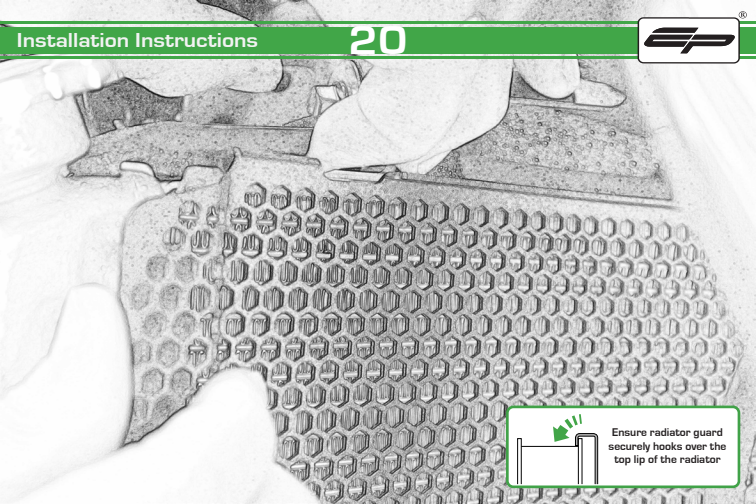

Ensure radiator guard  
securely hooks over the  
top lip of the radiator

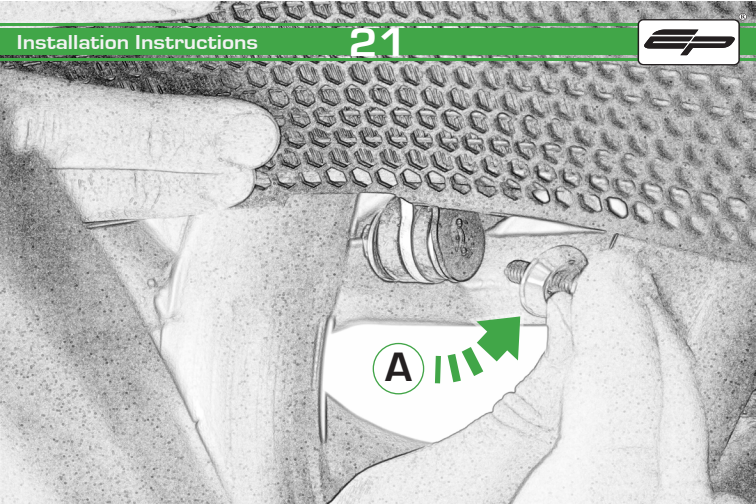

### ESSENTIAL CHECKS

It is recommended that periodic inspections are made to ensure that dirt and debris have not become trapped between the guard and the radiator/oil cooler. Such dirt and debris would reduce the cooling efficiency of the radiator/oil cooler.

It is recommended that periodic inspections are made to ensure that all fixings are fully tightened.



Reverse Stages

15 - 1



**EVOTECH**®  
P E R F O R M A N C E

[www.evotech-performance.com](http://www.evotech-performance.com)